

Mapping Notes

- Existing contours shown were generated from GRID information obtained from the West Virginia GIS Technical Center.

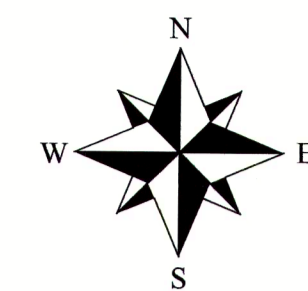

Legend

- Property Boundary
- Property to be Acquired
- Right-of-Way
- Existing Grade Contour (Index)
- Existing Grade Contour (Intermediate)
- Existing Stream
- Proposed Earthwork Limits
- Proposed Grade Contour (Index)
- Proposed Grade Contour (Intermediate)
- Proposed Grade Spot Elevation
- Cut/Fill Depth Difference (Ft.) Per DTM (Cell Size: 5'-0" x 5'-0")

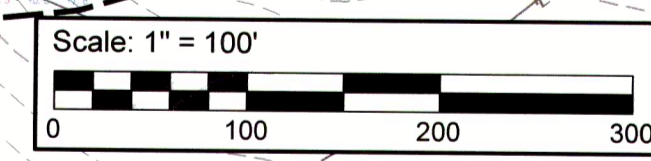
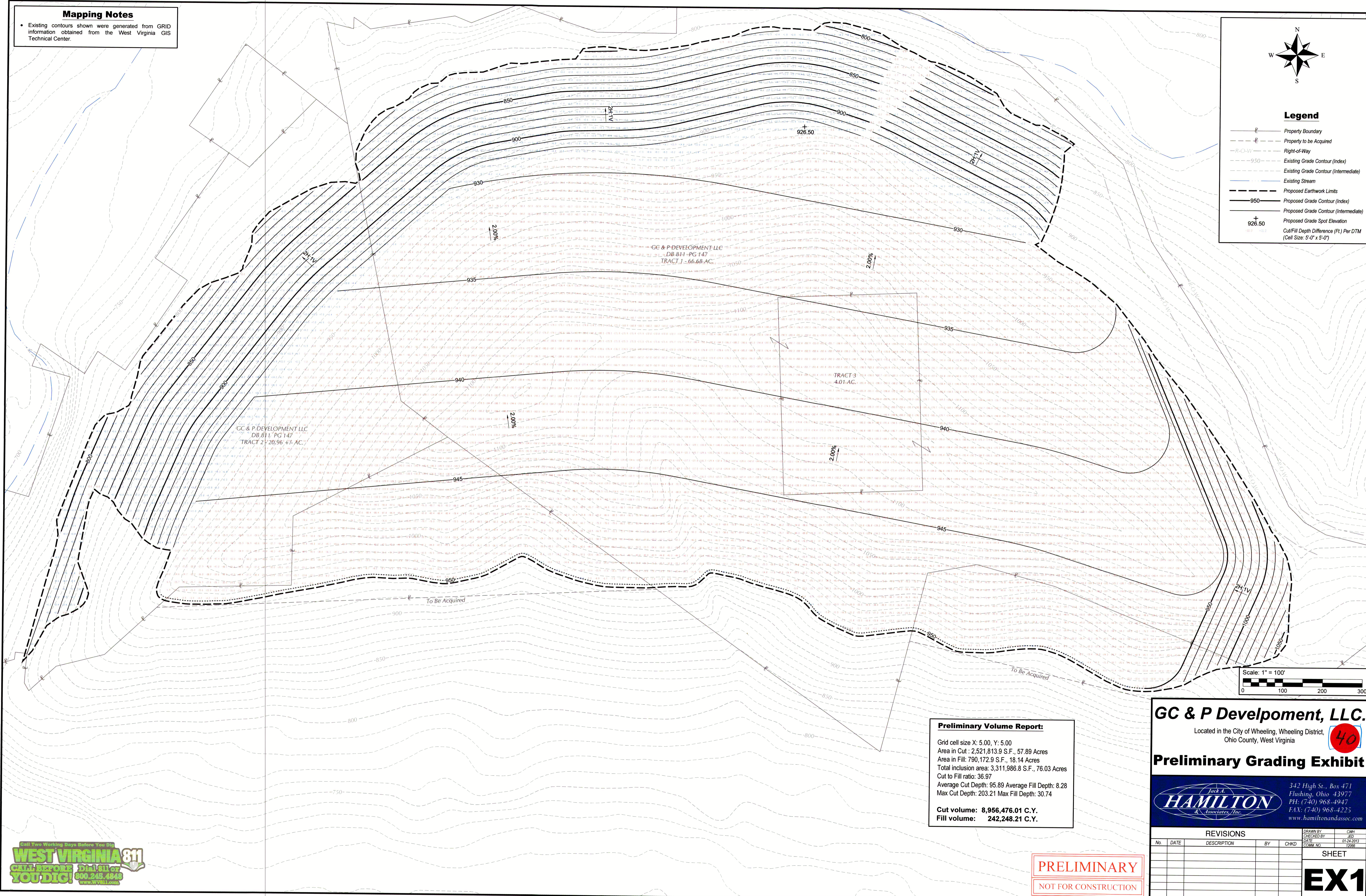

Preliminary Volume Report:
 Grid cell size X: 5.00, Y: 5.00
 Area in Cut : 2,521,813.9 S.F., 57.89 Acres
 Area in Fill: 790,172.9 S.F., 18.14 Acres
 Total inclusion area: 3,311,986.8 S.F., 76.03 Acres
 Cut to Fill ratio: 36.97
 Average Cut Depth: 95.89 Average Fill Depth: 8.28
 Max Cut Depth: 203.21 Max Fill Depth: 30.74
Cut volume: 8,956,476.01 C.Y.
Fill volume: 242,248.21 C.Y.

GC & P Development, LLC.
 Located in the City of Wheeling, Wheeling District,
 Ohio County, West Virginia

Preliminary Grading Exhibit

Jack A.
HAMILTON
 & Associates, Inc.

342 High St., Box 471
 Flushing, Ohio 43977
 PH: (740) 968-4947
 FAX: (740) 968-4225
 www.hamiltonandassoc.com

REVISIONS					DATE	CHKD
No.	DATE	DESCRIPTION	BY	CHKD	DATE	CHKD

DRAWN BY: CHM
 CHECKED BY: JED
 DATE: 01-24-2013
 DRAWING NO.: 1208

SHEET

PRELIMINARY
 NOT FOR CONSTRUCTION

EX1

